

**PACE**

## SX-70 Sodr-X-Tractor and Accessories

Note: SX-70 handpieces are provided with all Pace desoldering systems before July 2000. After this date, SX-80 is supplied. Tips used are not interchangeable.

Cat. No.	Description				
176-070	SX-70 Handpiece				
176-028	Replacement Visifilter				
176-027	Filter Elements for Visifilter 10/pk.				
176-265	Replacement Glass Chamber				
176-018	Felt Filters for Handpiece, 10/pk.				

Cat. No.	Description	Shank Dia.	I.D.	O.D.	
176-030	Thermo-Drive Tip	3/16"	.03"	.06"	
176-040*	Thermo-Drive Tip	3/16"	.04"	.07"	
176-060	Thermo-Drive Tip	3/16"	.06"	.10"	
176-494	Extended Reach Tip	3/16"	.04"	.085"	
176-463	Long Life Tip	3/16"	.04"	.085"	
176-036	Land Cleaning Tip	3/16"	.06"	.188"	
176-465	Land Cleaning/Long Life	3/16"	.06"	.196"	
176-253	Micro Tips	1/8"	.03"	-	
176-254	Micro Tips	1/8"	.04"	-	
176-255	Micro Tips	1/8"	.06"	-	
176-083*	Adaptip, allows use of 1/8" tips in SX-70 Handpiece				

\*Included with handpiece

**PACE**

## SX-80 Sodr-X-Tractor & Accessories

Note: SX-80 is provided with all PACE desoldering equipment after July 2000.

Cat. No.	Description	Dia. I.D.	Dia. O.D.	
176-780	SX-80 Sodr-X-Tractor Only			
178-790	Handpiece Stand for SX-80			
178-791	Replacement Flux/Sodr Trap, Pk/10			
176-703	Thermo-Drive Tip	.030	.080	
176-704	Thermo-Drive Tip	.040	.090	
176-705	Thermo-Drive Tip	.060	.120	
176-706	Ext. Reach Thermo-Drive Tip	.030	.090	
176-707	Ext. Reach Thermo-Drive Tip	.040	.100	
176-708	Precision Tip	.030	.080	
176-709	Precision Tip	.060	.110	
176-710	Land Cleaning Tip	.060	.188	

**PACE**

## PS-80 Sod-R-Pen and Accessories

Note: Following tips also fit older SP2A and IR-70 Sod-R-Pens

Cat. No.	Description	Size	
176-080	PS-80 Soldering Handpiece	-	
176-081	Handpiece Stand for PS-80	-	
176-403	Surface Mount	0.25"	Flat Blade
176-514	Surface Mount	0.4"	Flat Blade 2/pk.
176-416	Surface Mount	0.7"	Flat Blade 2/pk.
176-390	SOIC-8	.199"x.200"	
176-391	SOIC-14	.199"x.354"	
176-016	SOIC-16	.199"x.404"	
176-395	SOICL-24	.369"x.624"	
176-093	Chip Component	.093"x.08"	
176-014	Chip Component	.14"x.08"	
176-304	SOT-23	.063"x.12"	
176-481	PLCC-28 Socket	.45"x.45"	
176-429	PLCC-32 Socket	.55"x.45"	
176-430	PLCC-44 Socket	.65"x.65"	
176-432	PLCC-68 Socket	.95"x.95"	
176-445	PQFP-44/56	.46"x.46"	

Cat. No.	Description	Size	
176-357	Conical	1/64"	
176-336	Conical	1/32"	
176-361	Bent Chisel	1/32"	
176-414*	Chisel	1/16"	
176-034	Chisel, MicroFine	1/16"	
176-500	Bent Chisel, Long Reach	1/16"	
176-049	Mini-Wave Chisel	13/100"	
176-528	Conical, Long Reach	1/64"	
176-529	Chisel, Long Reach	3/32"	
176-531	Chisel, Long Reach	3/16"	
176-516	Conical, Thermo-Drive	1/64"	
176-518	Chisel, Thermo-Drive	1/8"	

\*Included with handpiece

**PACE**

## TT-65 ThermoTweez and Accessories

Cat. No.	Description	Size	
176-651	TT-65 ThermoTweez Handpiece		
176-035	Handpiece Cubby for TT-65		
176-314	PLCC-18	0.34 x 0.23"	
176-316	PLCC-20	0.27 x 0.27"	
176-317	PLCC-28	0.37 x 0.37"	
176-318	PLCC-44/PQFP-84	0.57 x 0.57"	
176-320	PLCC-68/PQFP-132	0.86 x 0.86"	
176-321	PLCC-84/PQFP-160	1.06 x 1.06"	
176-313	Chip, Vertical	0.08"	
176-402	Chip, Vertical/SOIC	0.25"	
176-043	Chip, Angled	0.10"	
176-521	Chip, Vertical/Thin Wall	0.08"	
176-517	Chip, Angled Fine Point	0.017"	
176-416	SOIC, SOJ/SIMMs	0.7"	
176-448	SOIC, SOJ/SIMMs	1.0"	
176-475	Surface Mt. Connectors	1.5"	
176-419	{ Motorola Pager }	0.28 x 0.28"	
176-425	{ LCCC Packages }	0.40 x 0.35"	

**PACE**



Cat. no. 176-250

**PACE**



**TP-65 ThermoPik and Accessories**

Cat. No.	Description	Size
176-065	TP-65 ThermoPik Handpiece	-
176-044	Handpiece Cubby	-
176-993	Replacement Vacuum Cup with Needles (S,M,L)	-
176-322*	FlatPack Tip	0.66 x 0.90"
176-323	PQFP-68 Tip	0.62 x 0.62"
176-324	PQFP-84 Tip	0.72 x 0.72"
176-326	PQFP-132 Tip	1.02 x 1.02"
176-456	PQFP-144 Tip	1.15 x 1.15"

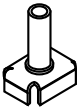

\*Included with handpiece

**TJ-70 Mini ThermoJet and Accessories**

Cat. No.	Description	Size
176-650	TJ-70 ThermoJet Handpiece	-
176-044	Handpiece Cubby	-
176-338*	Single Jet, Curved Tip	-
176-330	Dual Jet, SOIC Tip	.17" (gap)
176-371	Flat End Tip	.24"x .074"



\*Included with handpiece

**PACE**

**Conductive Rework/Repair**

**MBT-250SDPT**

The MBT-250SDPT provides an advanced, microprocessor-based Thermal management Center which powers and controls three SensaTemp handpieces simultaneously for safe, rapid, installation and removal of virtually all surface mount and thru-hole components.



**The MBT 250SDPT provides:**

- AUTO SNAP-VAC Thru-hole Desoldering System
- "QUIET FLO" pump for vacuum and pressure
- Full range 2-sided and 4-sided SMT component installation and removal
- Advanced microprocessor performance and convenience
- Operates any three SensaTemp handpieces simultaneously
- Automatic or Manual Tip Temperature Setback and Power Down, Constant Memory
- Automatic Tip Offset Compensation System

**AUTO SNAP-VAC SYSTEM improves thru-hole desoldering performance, increases tip life!**

PACE's patented AUTO SNAP-VAC quick rise vacuum system provides an automatic minimum vacuum on-time of 1.2 seconds. Re-sweat joints, tip clogging and maintenance are virtually eliminated, and tip life dramatically increased! Snap-Vac removes solder from even the thickest multilayer boards in less than 100ms, leaving holes clean, and eliminating lifted pads and board damage.

**"QUIET FLO" Pump for vacuum and air pressure!**

Working in close quarters? PACE's NEW "QUIET FLO" Pump insures peace and solitude for you and your neighbors! Quick-disconnect vacuum for the Sodr-X-Tractor and ThermoPik, and Controlled Full-Range air pressure for the Optional Mini ThermoJet Handpiece, make the "QUIET FLO" pump the popular, versatile choice for your benchtop today.

## Advanced Microprocessor Performance and Convenience Temperature Selection, Range, Calibration and Lock-out

Cat. no. 176-250

Tip temperatures may be precisely selected between 38° and 482°C (100° and 900°F). Tip Offset Constants are adjustable between 3 and 139 for °C (6 and 250 for °F) and are internally adjusted automatically when changing Tip Temperature Settings. In calibration mode, the available Tip Temperature range for each channel may be limited, if desired. Temperature recalibration is quickly and easily done right on the front panel with the optional Calibration Kit. An optional lock is also available which prevents unauthorized recalibration or alteration of temperature settings. All temperature settings, offsets, ranges and calibrations for each channel are retained in a non-volatile memory for later use, even after the unit is turned off.

### Automatic or Manual Temperature Set Back and Power Down

To preserve tip life and save energy, the unit can be programmed so that each channel will independently set back its Tip Temperature after a selected period of handpiece inactivity. For added safety, power to all three channels is switched off 90 minutes after the last channel's temperature is set back. Previous temperature settings are quickly and easily restored by striking any key.

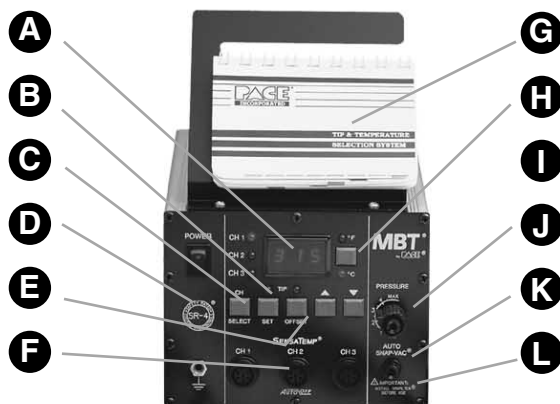

- |   |   |
|---|---|
| <p><b>A Digital Readout</b><br/>Displays the Current Channel's temperature information, error codes and programming status.</p> <p><b>B Tip Temperature Set Key</b><br/>Puts system in TIP TEMP SET Mode to enter and display Set Tip Temperatures.</p> <p><b>C Channel Select Key</b><br/>Selects the "Current Channel" whose temperature information is set and displayed on the Digital Readout.</p> <p><b>D Keyboard Entry Microprocessor Control</b><br/>All system settings are entered on a "User Friendly" array of keys with audible feedback.</p> <p><b>E Tip Temperature Offset Key</b><br/>Puts System in TIP TEMP OFFSET Mode to enter Tip Offset Constant for selected handpiece and Tip.</p> <p><b>F High Power, 3 Channel System</b><br/>Three SensaTemp handpieces are independently powered and controlled for maximum flexibility.</p> | <p><b>G PACE's Tip &amp; Temperature Selection System Charts</b><br/>Makes choosing the right tip and temperature or the job easy.</p> <p><b>H C/°F Selector Key</b><br/>Displays Set and Operating Tip Temperatures in either Fahrenheit or Centigrade.</p> <p><b>I Scroll Keys</b><br/>Rapidly selects Tip Offset Constants and Set Tip Temperatures.</p> <p><b>J CONTROLLABLE AIR PRESSURE PORT</b><br/>Provides precise, controlled quiet air flow for optional Mini ThermoJet operation.</p> <p><b>K AUTO SNAP-VAC PORT</b><br/>Provides AUTO SNAP-VAC Quick Rise /vacuum with an automatic 1.2 second /vacuum on time for High Performance, Low Maintenance Thru-Hole Desoldering and ThermoPik operation.</p> <p><b>L VisiFilter</b><br/>The VisiFilter with replaceable element traps flux residue.</p> |
|---|---|



Cat. no. 176-250

**SPECIFICATIONS**

MBTSDPT  
P/N 8007-0206  
115VAC, 60Hz, 185 Watts

**DIMENSIONS**

135mm H x 165mm W x  
260mm D  
(5.3" H x 6.5" W x 9.25" D)

**STANDARD HANDPIECES/MBT 250A**

PS-80 Soldering Iron  
SX-80 Sodr-X-Tractor  
TT-65 Thermo Tweez  
TP-65 Thermo Pik

**2 New Shop-Air Systems!**

MBT 250V  
P/N 8007-0235  
115VAC, 60Hz, 185 Watts

